

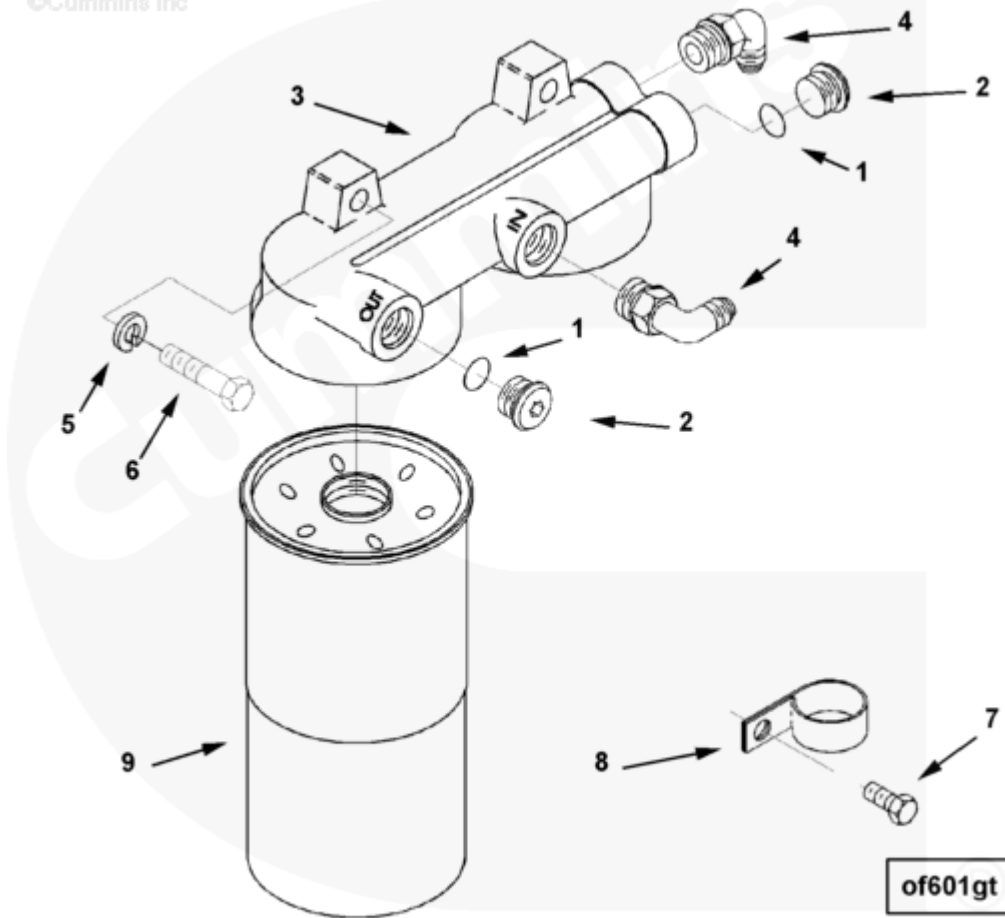

Parts Catalog - Option Detail

Electronic Parts Catalog - Option Detail				
Option	Group	Graphic	Film Card	Date
OF6005-07	07.03	of601gt	K38	01-JAN-03
Engines	GTA38, K38, KTA38GC CM558, QSK38 CM2150 K106, QSK38 CM2150 MCRS, QSK38 CM850 MCRS			

©Cummins Inc



[SMALL](#) | [MEDIUM](#) | [LARGE](#)

Cart	Ref No	Part Number	Part Description	Required	Remarks
View My Cart					
		OF6005-07	Bypass Oil Filter		Dual element by-pass lube oil...(More)
					filter, with replaceable
					spin-on cartridges,
					Mounted on pan rail, right

					bank side of engine.
<input type="checkbox"/>	1	43696 A	O-Ring Seal	2	
<input type="checkbox"/>	2	139473	O-Ring Plug	2	7/8 - 14 UNF.
<input type="checkbox"/>	3	3033405	Lubricating Oil Filter Head	1	
<input type="checkbox"/>	4	3177198	Male Union Elbow	2	
<input type="checkbox"/>	5	S 610	Lock Washer	2	7/16 in.
<input type="checkbox"/>	6	106069	Hexagon Head Cap Screw	2	7/16 - 14 X 2 in.
<input type="checkbox"/>	7	3065723	Captive Washer Cap Screw	1	3/8 - 16 X 1 3/4 in.
<input type="checkbox"/>	8	3627412	Clip	1	
<input type="checkbox"/>	9	3889311	Oil Bypass Filter Element	2	

© 2019 Cummins Inc., Box 3005, Columbus, IN 47202-3005 U.S.A.
Terms of Use and Disclaimers | Recommended System Requirements
Need Assistance? Please click on the Contact Us button in the top right corner of any page.